

SAFT/LITE

CONTACT US AT:

Internet: www.saftlite.com
OR

E-mail: sales@saftlite.com

OPERATING INSTRUCTIONS
AND PARTS LIST FOR

4000 SERIES

ELECTRICAL CORD
REELS

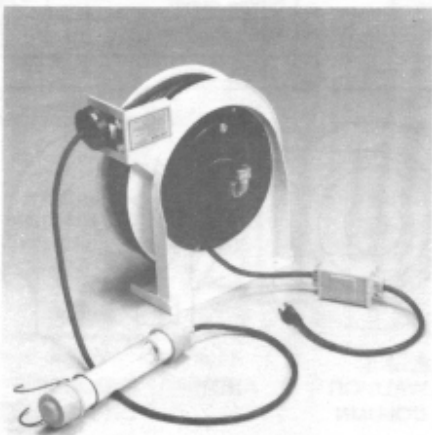
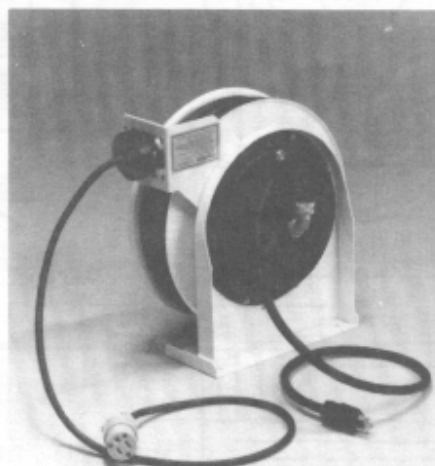
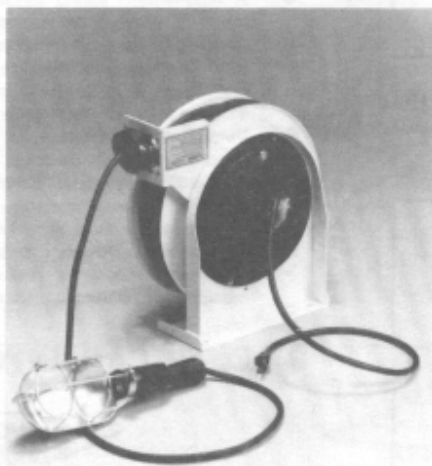

IMPORTANT

**READ THIS MANUAL CAREFULLY BEFORE INSTALLING,
OPERATING, OR SERVICING THIS EQUIPMENT**

DIMENSIONAL DATA

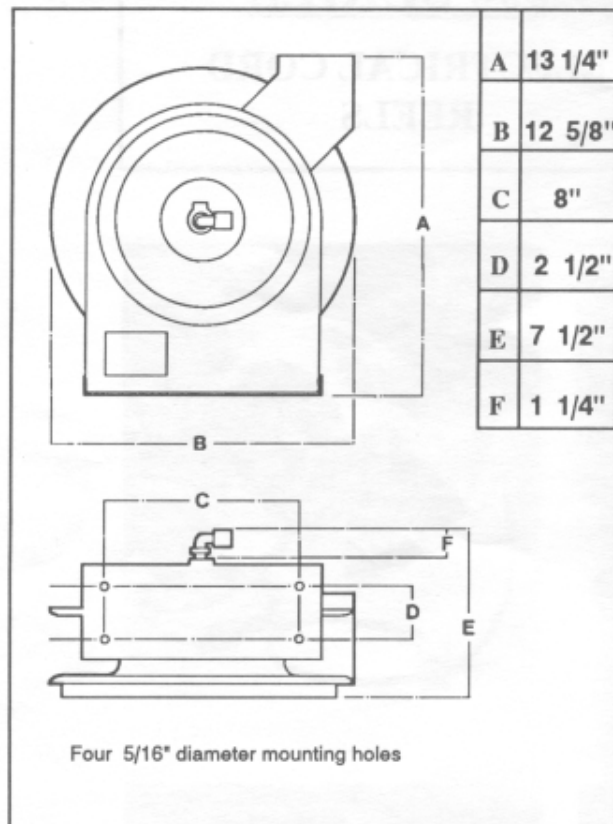

PERSONNEL SAFETY

Personal injury and/or equipment damage may result if proper safety precautions are not observed.

- Ensure that power supply voltage does not exceed maximum voltage rating of reel.
- Ensure that reel is properly installed before connecting to power supply.
- Ensure that all electrical power is removed from reel before servicing.
- A high-tension spring assembly is contained within the reel. Exercise extreme caution.
- Check for frayed and/or broken wires before each use.
- Pull electrical cord from reel by grasping the electrical cord itself, not the work device.
- If an electrical malfunction should occur, remove power from reel immediately.
- Ensure that reel, electrical cord, and equipment being serviced are properly grounded. Use an ohmmeter to check ground continuity.
- If reel ceases to unwind or rewind, remove power immediately. Do not pull or jerk on electrical cord!
- Treat and respect the reel as any other piece of machinery, observing all common safety practices.

ELECTRICAL INFORMATION

	VOLTAGE A/C	AMPS	FREQUENCY
Incandescent lamp (75 watt max.)	115	15	60HZ Single phase
Flourescent lamp	115	.3	
Single outlet	115	15	
Duplex outlet	115	15-20	

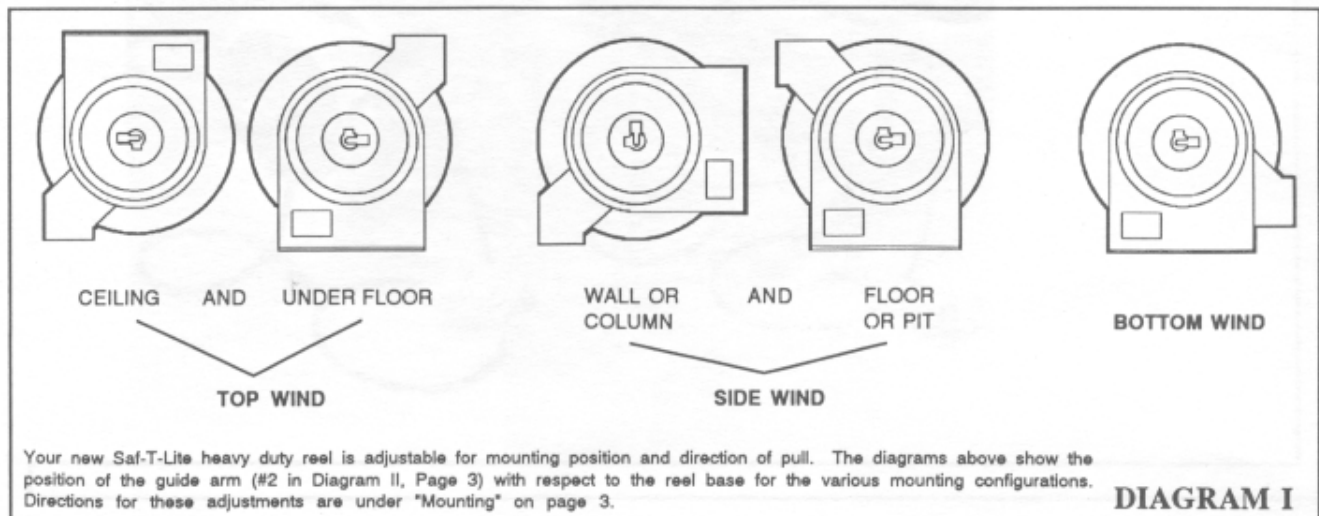

DIAGRAM I

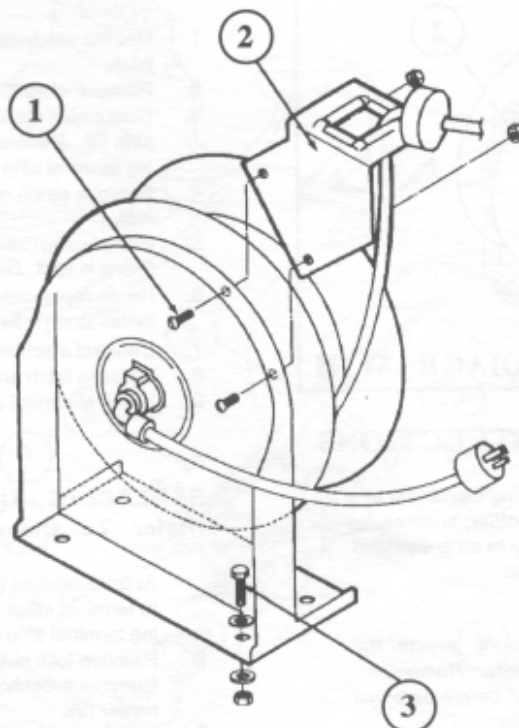

DIAGRAM II

MOUNTING

1. Unpack and inspect reel for damage. Turn by hand to check for smooth operation. Check for completeness.
2. Configure reel for top, side or bottom-wind (bottom-wind for constant tension reels only) electrical cord dispensing by removing screws (1), securing guide arm bracket (2). Determine new guide arm location and remove corresponding screws. Position guide arm bracket to reel and replace screws.
3. Position reel on floor, wall, or ceiling. Secure into place, using four (customer supplied) screws or bolts (3).
4. Connect power to reel.

CAUTION: Unless the reel was specified differently when ordering, the maximum installation height is 16 feet. Do not exceed this distance.

WARNING: Ensure that power supply voltage does not exceed maximum voltage rating of reel. Refer to page 6 for applicable electrical ratings.

Observe applicable NEC, OSHA, and local electrical codes.

ADJUSTMENTS

SPRING TENSION

If necessary, adjust spring tension on reel by adding or removing wraps of electrical cord from spool, one wrap at a time, until desired tension is obtained. Add wraps to increase tension. Remove wraps to decrease tension.

WARNING: When adding wraps of electrical cord, be careful not to exceed the winding mechanism's spring capacity. Add just enough wraps of cord to achieve the desired tension. Damage to the winding mechanism will result if spring is over-tensioned.

Always beware of spring tension on reel. Exercise extreme caution.

CAUTION: To eliminate heating and damage to reel cord, pull all cord from reel if electrical load approaches maximum rating.

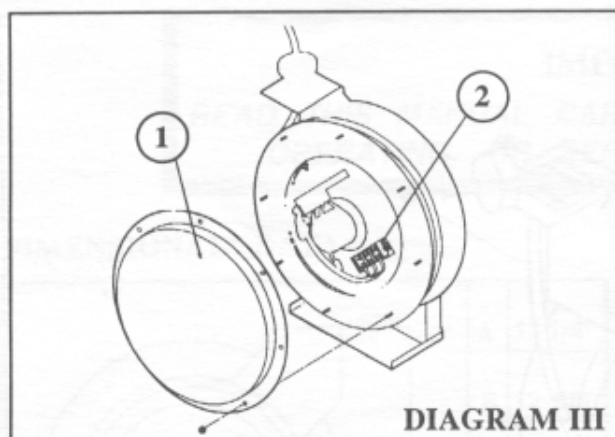

TROUBLESHOOTING INSTRUCTIONS

Troubleshooting of the reel consists of isolating a problem to a defective electrical cord/work device, brushholder, brushes, or collector. Refer any other discrepancies only to an authorized service person or directly to General Manufacturing.

WARNING: The following procedure directs the technician to take voltage measurements. Remember, even low voltage is dangerous and can cause personal injury or death. Exercise extreme caution!

1. If work device is either an incandescent or fluorescent light, replace bulb with a known good bulb. If this does not correct the problem, proceed to step 2. If work device is an electrical receptacle, ensure that tool or fixture connected to it is in good working order. If it is, proceed to step 2.
2. Remove power from reel.
3. Remove access cover (1).
4. Reapply power to reel.
5. Check for correct voltage at terminal strip (2). If voltage reading is correct, replace electrical cord/work device (refer to SERVICE INSTRUCTIONS). If voltage reading is incorrect, proceed to step 6.
6. Remove power from reel.
7. Remove brushholder from reel and inspect brushholder and brushes (refer to SERVICE INSTRUCTIONS). Replace defective components. Proceed to step 8.
8. Reapply power to reel.
9. Check for correct voltage at terminal strip (2). If voltage reading is still incorrect, replace defective collector (refer to SERVICE INSTRUCTIONS).
10. Replace access cover (1).

SERVICE INSTRUCTIONS

Maintain reel by following the service instructions given below. Refer all other repairs, other than those listed, only to an authorized service person or directly to General Manufacturing. Failure to do so can result in personal injury and/or equipment damage and may void the warranty.

WARNING: Remove power from reel before performing the following procedures.

REPLACING THE ELECTRICAL CORD/ WORK DEVICE (Refer to Diagram IV)

1. Unwind electrical cord from reel until fully extended, then latch.
2. Remove electrical cord bumper (1).
3. Disconnect electrical cord/work device (2) at terminal strip (3). Record color coding of wires and corresponding terminal strip terminals.
4. Remove strain relief (4). Remove remainder of cord from reel.
5. While facing collector side of reel, turn reel clockwise until spring is tight. Back-off three turns, then latch.
6. Route replacement electrical cord/work device (2) and install strain relief (4).
7. Connect electrical cord to terminal strip (3).
8. Release latch and rewind electrical cord on reel.
9. Install electrical cord bumper (1).

REPLACING THE BRUSHHOLDER (Refer To Diagram IV)

1. At terminal strip (3), remove wires connecting brushes (7) to terminal strip. Record wire numbers and corresponding terminal strip terminals.
2. Remove lock nuts (8) securing brushholder (9) to reel. Remove brushholder. Remove brushes (7) from brushholder (9).
3. Install brushholder by reversing steps 1 through 3. Upon completion of installation, adjust brush-to-ring alignment by loosening screws (5) and sliding finger assembly (6) up and down.

REPLACING BRUSHES (Refer to Diagram IV)

1. At terminal strip (3), remove wires connecting brushes (7) to terminal strip. Record wire numbers and corresponding terminal strip terminals.
2. Remove lock nuts (8), securing brushholder (9) to reel. Remove brushholder. Remove brushes (7) from brushholder (9).
3. Install brushes by reversing steps 1 through 3. Upon completion of installation, adjust brush-to-ring alignment by loosening screws (5) and sliding finger assembly (6) up and down.

REPLACING THE COLLECTOR (Refer To Diagram IV)

1. Remove wire nuts (10). Record wire numbers. Observe color coding.
2. At terminal strip (3), remove wires connecting brushes (7) to terminal strip. Record wire numbers and corresponding terminal strip terminals.
3. Remove lock nuts (8) securing brushholder (9) to reel. Remove brushholder.
4. Remove coupling nut (11).
5. Remove collector (12).
6. Install collector by reversing steps 1 through 5. Upon completion of installation, adjust brush-to-ring alignment by loosening screws (5) and sliding finger assembly (6) up and down.

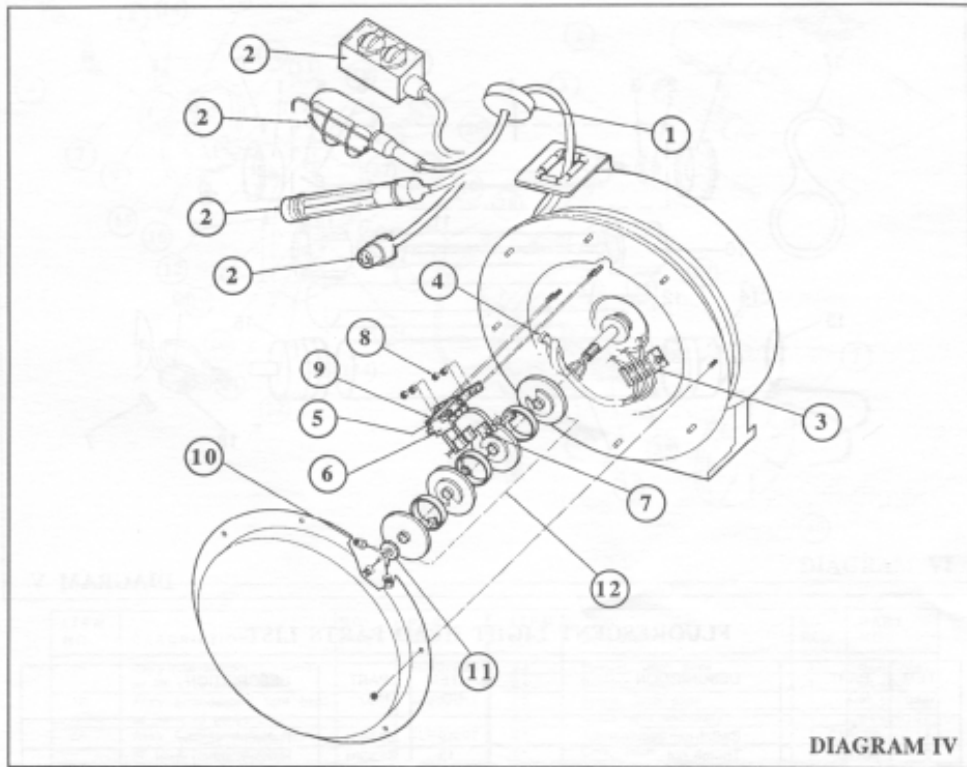

MODEL NUMBER CHART

MODEL NUMBER	DESCRIPTION	Max. Amps	REEL CORD	
			Length	Gauge
4035-1601	Heavy duty reel with incandescent light head & tool tap	13	35'	16
4050-1301	Heavy duty reel with incandescent light head & tool tap	13	50'	16
4035-2334	Heavy duty reel with Stubby fluorescent light head	.3	35'	16
4050-2334	Heavy duty reel with Stubby fluorescent light head	.3	50'	16
4035-2000	Heavy duty reel with 15 watt fluorescent light head	.2	35'	16
4050-2000	Heavy duty reel with 15 watt fluorescent light head	.2	50'	16
4035-3600	Heavy duty reel with single power outlet	13	35'	16
4050-3600	Heavy duty reel with single power outlet	13	50'	16
4035-3400	Heavy duty reel with single power outlet	15	35'	14
4045-3400	Heavy duty reel with single power outlet	15	45'	14
4035-4601	Heavy duty reel with duplex power outlet & ground fault breaker	13	35'	16
4050-4601	Heavy duty reel with duplex power outlet & ground fault breaker	13	50'	16
4035-4401	Heavy duty reel with duplex power outlet & ground fault breaker	15	35'	14
4045-4401	Heavy duty reel with duplex power outlet & ground fault breaker	15	45'	14
4035-4200	Heavy duty reel with duplex power outlet less ground fault breaker	20	35'	12
4040-4200	Heavy duty reel with duplex power outlet less ground fault breaker	20	40'	12

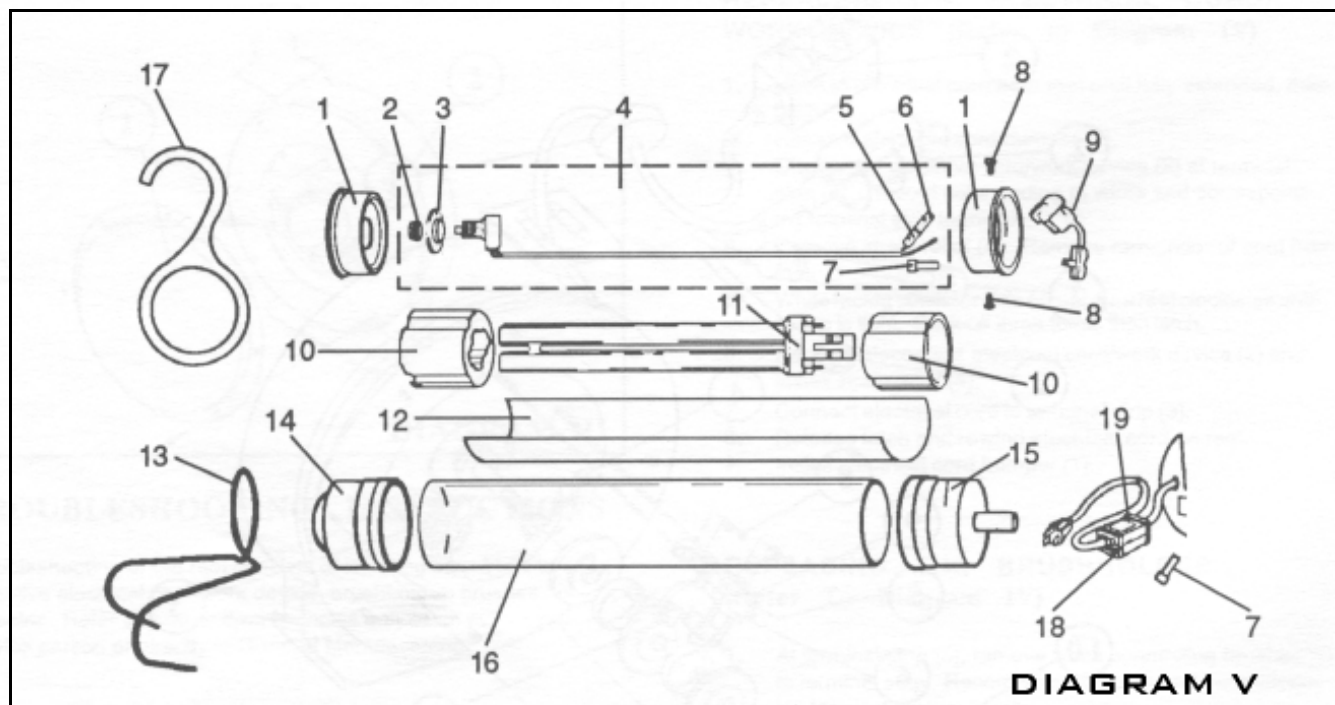

FLUORESCENT LIGHT HEAD PARTS LIST

ITEM NO.	PART NO.	DESCRIPTION	ITEM NO.	PART NO.	DESCRIPTION
1	5000-0397	Switch cap, commercial	12	5000-00459	Reflector, Stubby
2	5000-0398	Thumb nut	13	5000-0460	Hanger, spring steel
3	5000-0399	Plastic washer	14	5000-0462	End cap, switch end, yellow
4	5000-0469	Switch (includes 2,3,5,6 & 7)		5000-0463	End cap, switch end, black
5	5000-0245	Pin terminal, female	15	5000-0408	End cap, cord end, yellow
6	5000-0244	Sleeve, female		5000-0464	End cap, cord end, black
7	5000-0400	Connector, (closed end insulated)	16	5000-0465	Outer tube
8	5000-0402	Screw	17		Hanger, vinyl
9	5000-0403	Strain relief	18	5166-3516	Ballast, 13W Stubby (USA only)
10	5000-0404	Lampholder	19	5166-3544	Ballast box & lid—yellow w/4 screws
11	5000-2003	Lamp, 13 watt rough service	20	5165-9501	Replacement light head, Stubby

HOW TO ORDER REPLACEMENT PARTS

Please provide the following information:

- Model Number
- Serial Number
- Part description and number as shown in parts list

Address order to:

General Manufacturing Inc.
1336 West Wiley Avenue
Bluffton, IN 46714

ELECTRICAL INFORMATION

	VOLTAGE A/C	AMPS	FREQUENCY
Incandescent lamp (75 watt max.)	115	15	60HZ Single phase
Fluorescent lamp	115	.3	
Single outlet	115	15	
Duplex outlet	115	15-20	

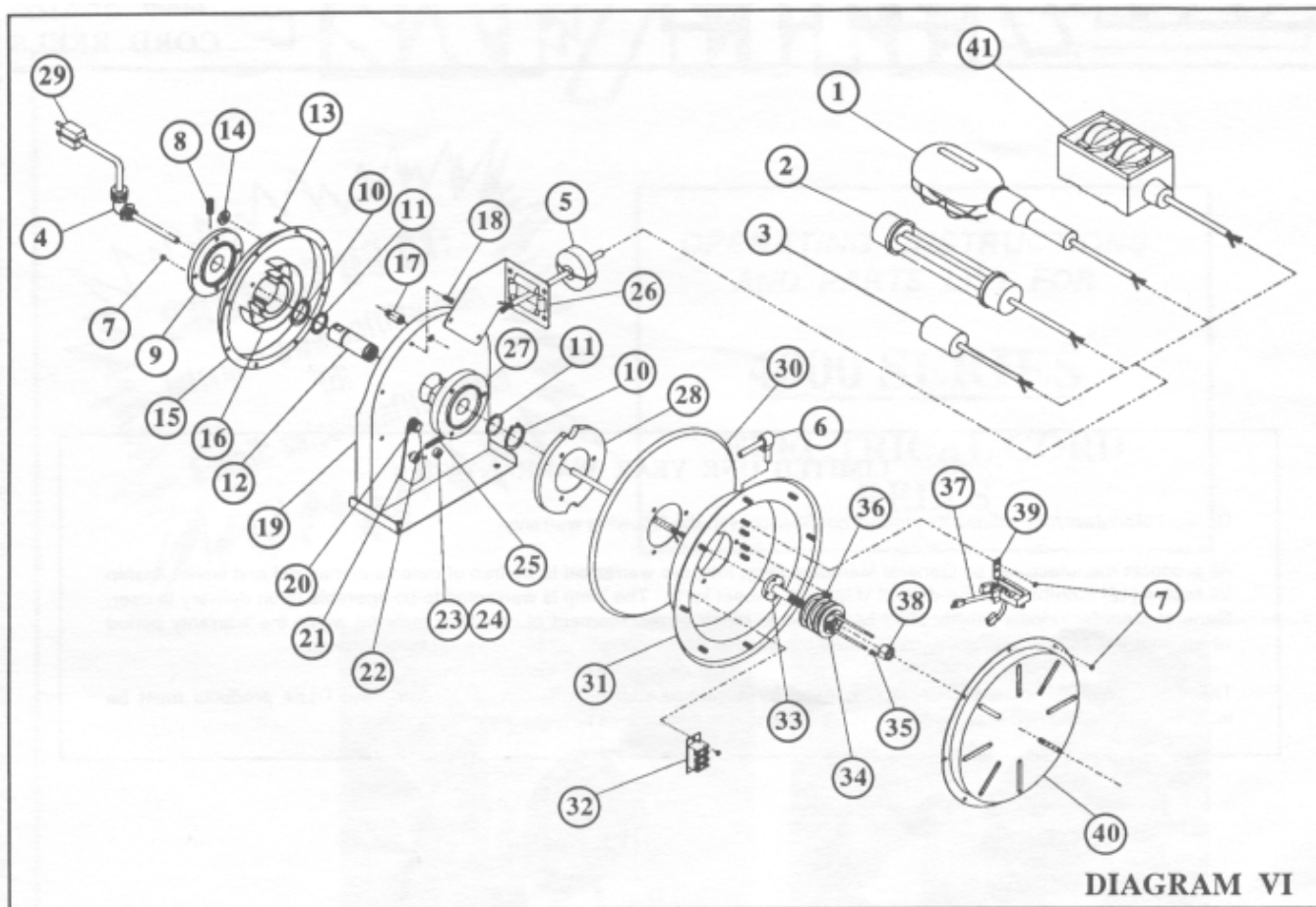

ITEM NO.	DESCRIPTION	NO. REQ.	PART NO.	ITEM NO.	DESCRIPTION	NO. REQ.	PART NO.
1A	Assembly Incandescent light head w/ 35' x 16 gauge cord SL600223	1	5000-6316	23	Bumper, latch plate SL400021	1	5000-0141
1B	Assembly Incandescent light head w/ 50' x 16 gauge cord SL600212	1	5000-6025	24	Bushing, latch SL400012	1	5000-0142
2A	Assembly Fluorescent light head w/ 35' x 16 gauge cord SL600207	1	5000-6024	25	Spring, latch plate SL400018	1	5000-0143
2B	Assembly Fluorescent light head w/ 50' x 16 gauge cord SL600211	1	5000-6009	26	Guide arm assembly SL400107	1	5000-0144
3A	Assembly single outlet w/ 35' x 16 gauge cord SL600209	1	5000-6317	27	Arbor, spring SL400017	1	5000-0145
3B	Assembly single outlet w/ 50' x 16 gauge cord SL600209	1	5000-6005	28	Cam, latch SL400019	1	5000-0146
4	Wire grip assembly SL600215	1	5000-0123	29A	Pigtail, 6' x 16 gauge With grounded plug SL600214	1	5000-6098
5	Bumper assembly SL600193	1	5000-0533	29B	Pigtail, 6' x 16 gauge SL600213 w/fluorescent ballast, w/grounded plug	1	5000-6099
6	Relief, strain SL260501	1	5000-0124	29C	Pigtail, 6' x 14 gauge With grounded plug SL600220	1	5000-6100
7	Nut, hex lock-dbl. Serrated SL300011	21	5000-0125	30	Disc, sheave SL400006	1	5000-0147
8	Screw, set 3/8" -16 x 1/2" pin SL300006	1	5000-0126	31	Sheave & stud assembly SL600194	1	5000-0148
9	Hub SL400016	1	5000-0127	32	Terminal block assembly SL600205	1	5000-0149
10	Ring, snap 1 SL300031	2	5000-0128	33	Shaft, flange SL260516	1	5000-0150
11	Washer, spacing SL300034	2	5000-0129	34	Slip ring assembly * SL600201	1	5000-0151
12	Shaft, main 3/8 NPT x 3/4-16 SL400015	1	5000-0130	35	Nut, wire SL250500	3	5000-0152
13	Nut, lock 10-32 nylon SL300017	1	5000-0131	36	Screw, machine 1/4-20 x 5/8" SL300036	3	5000-0153
14	Nut, jam 3/8-24 zinc SL300013	1	5000-0132	37	Brushes * SL600201	3	5000-0151
15	Spring case & stud assembly SL600103	1	5000-0133	38	Nut, coupling SL260505	1	5000-0155
16	Drive spring assembly SL400030	1	5000-0134	39	Brush assembly * SL600201	1	5000-0151
17	Stud, spring case SL260064	1	5000-0135	40	Cover SL260510	1	5000-0157
18	Screw, machine SL300002	2	5000-0136	41A	Assembly GFCI duplex outlet w/ 35' x 16 gauge cord SL600219	1	5000-6292
19	Base assembly, red SL400101	1	5000-0137	41B	Assembly GFCI duplex outlet w/ 50' x 16 gauge cord SL600216	1	5000-6028
20	Ring, "O" SL400020	1	5000-0138	41C	Assembly GFCI duplex outlet w/ 35' x 14 gauge cord SL600217	1	5000-6314
21	Latch plate assembly SL400109	1	5000-0139	41D	Assembly GFCI duplex outlet w/ 50' x 14 gauge cord SL600218	1	5000-6315
22	Screw, machine SL300035	1	5000-0140				

* Only available as an assembly which includes items 34, 37 and 39



**4000 SERIES
CORD REELS**

LIMITED ONE YEAR WARRANTY

General Manufacturing affirms its product confidence with the following warranty:

All products manufactured by General Manufacturing, Inc. are warranted to be free of defects in material and workmanship for twelve (12) months from date of shipment, except lamps. The lamps are warranted to be operable upon delivery to the user. General Manufacturing's liability shall be limited to repair or replacement of defective material within the warranty period when returned, freight prepaid, to its plant or to a service depot designated by General Manufacturing, Inc..

This warranty does not cover damage caused by accident, abuse, or faulty installation. Saf-T-lite products must be installed and maintained in compliance with the manual of instructions furnished with each reel.

GENERAL MANUFACTURING, INC.

1336 W. Wiley Ave.—BLUFFTON, IN 46714

PHONE: 260-824-3440

FAX: 260-824-3448

Internet: www.saftlite.com

E-mail: sales@saftlite.com